

# Appendices

## Appendix A: different existing connections

### Different connections

There are already many different connections and ways to connect different parts together. We can look at whether these existing connections could be a good option for our concepts.

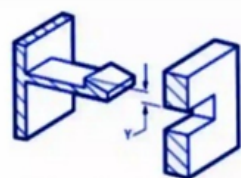
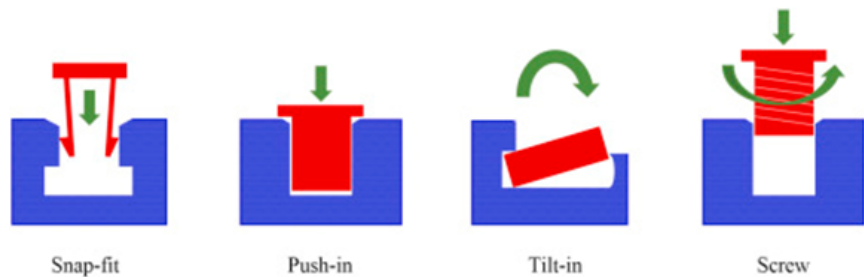
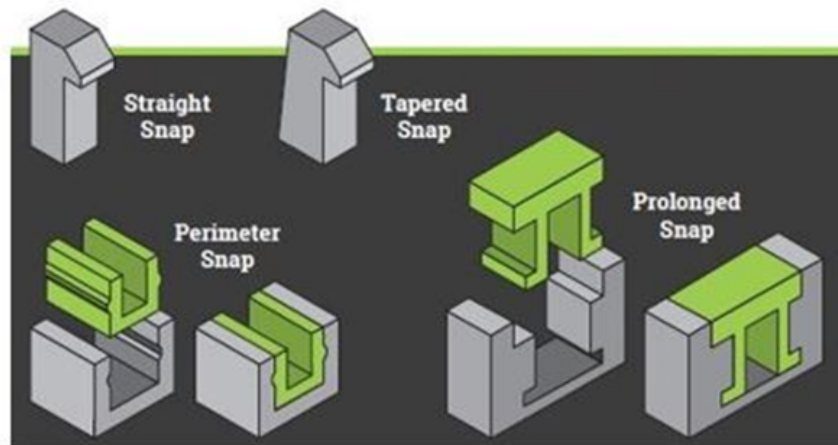

Cantilever Snap Joints



L-Shaped Snap Joints

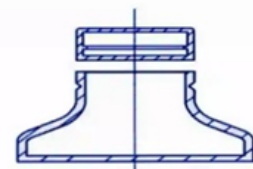

Annular Snap Joints



U-Shaped Snap Joints

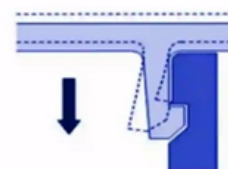

Torsion Snap Joints

**Clicking connection in glasses**

There are already some glasses where you can click on a part, as an extension of the glasses. The possibility of clicking on different parts for the concepts could be explored.



**Slides around the legs of the glasses**

There must also be found a way by which, the glasses can be sealed off from the glasses to the face. One way to do that is by sliding a (plastic) part over the leg of the glasses.



## Magnetic connection

There are already more ways by which, the glasses can be sealed off from the glasses to the face. Another way is to click a component to the frame using magnets. There are also already versions of this in different colours. More transparent and a somewhat darker color.

<https://www.youtube.com/watch?v=Xj1iZ6b5BoY>





**Slides around the legs of the glasses and is connected in the middle with a push button**

This way, the part that closes the glasses is scrolled back over the legs, but in this way, it is additionally secured by means of a push button in the center of the frame.



## Detachable eyecup

There is another existing way in which the part that closes the glasses is made detachable. The part is of a soft plastic/silicone which is thus easily deformable. On the frame there are hooks that stick out and in the closing part there are a kind of slots. You can press the slots around the hooks and in this way you can attach the parts together.



## Optician glasses

When eyes are measured at an optician's office, glasses are often used in which several glasses can be placed one after the other. At the optician, it is used to find the correct prescription. But it could be an option for the concepts for the project to also make glasses in which multiple glasses can be placed behind each other.

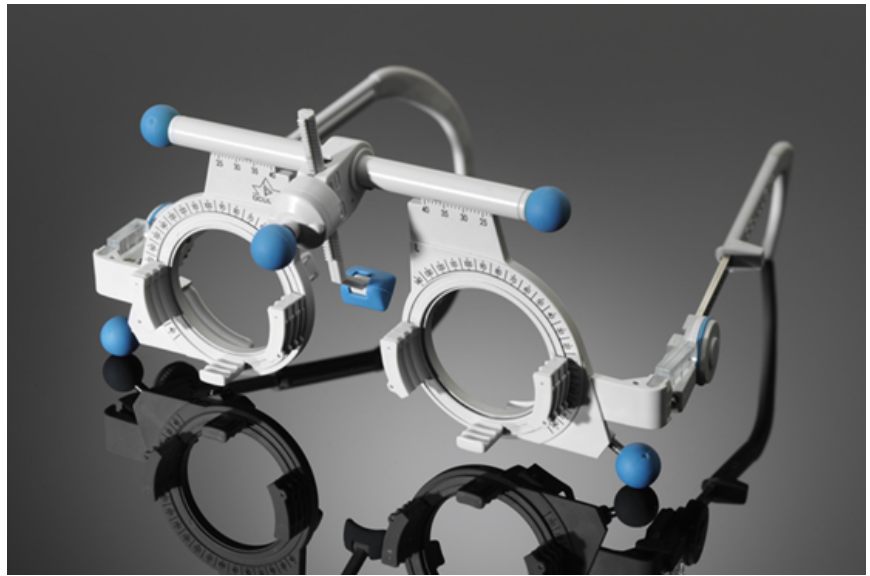

## Other features

Many other features already exist in eyewear that might also be useful for our concepts. For example, there are glasses with flexible legs, glasses in which a moisturizing chamber has been added. Also, a lot of glasses already exist whose lenses can be replaced. There are also glasses with a string that goes around your head. This makes the glasses stay on your head better.





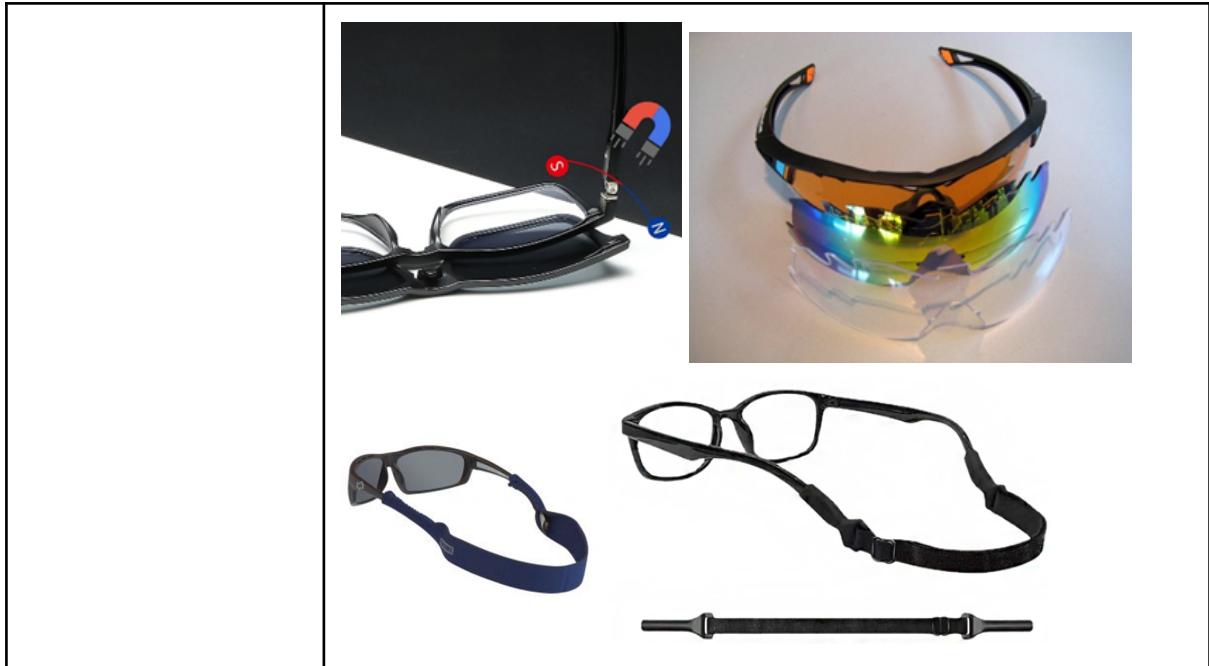

## Appendix B: general existing glasses

In this project, it is the intention that the final design can be used by a broader target group than just that of the Co-designer. So, the glasses must be usable for several groups with perhaps different problems. That is why it is important to do general research on different types of glasses.

Of course you have glasses in all shapes, sizes and for different purposes. In this research we have divided the glasses into the following subgroups: Different Strengths

### **Different prescriptions:**

#### Reading Glasses:

As can be concluded from the name, these glasses are intended for reading small print from close by. Reading glasses have lenses that only function for close-up and if the eyes do function well for long-sight, in most cases you do not need any other glasses for close-up than reading glasses.

#### Computer Glasses:

Computer glasses have similar properties to those of reading glasses, but are intended for use behind the laptop. Computer glasses neutralize blue light and reduce glare from the screen.

#### Single-Vision Glasses:

Single-Vision Glasses are the solution for people who are nearsighted or farsighted. If you are nearsighted you have 'minus lenses' and if you are farsighted you have 'plus lenses'. If you are nearsighted you will not see well at a distance and if you are farsighted you will not see well up close.



## Combined Glasses

### Multifocal Glasses:

The multifocal glasses are glasses that can be used for people who are nearsighted and farsighted at the same time. The lenses of progressive glasses are divided into two halves: the lower half is for close vision and the upper half is for distant vision. The transition between these halves is smooth, so the distances in between are also clearly visible.

### Prescription sunglasses:

Another pair of glasses that has multiple functions is the prescription sunglasses. These glasses are made on prescription, but at the same time can also serve as sunglasses in sunny weather.



Glasses for different types of light

### Driving Glasses:

You often have to deal with very bright lights in the car and even if you almost close your eyes, this does not help. For this problem you can put on driving glasses with orange-brown road view lenses, so that you are less bothered by bright light or glare.

### Night Glasses:

Night Glasses are also often worn in the car, but especially in the dark. The eyes can get tired quickly during night rides. These Night Glasses have Night-View lenses and ensure that you can see more depth and the headlights of oncoming vehicles are less bright.



### **Sport Glasses**

There are also a lot of glasses that are used for other purposes, such as for sports. These sports glasses then ensure that your eyes stay out of the wind and you can withstand the sun, such as cycling and skiing, but can also ensure that no water gets into your eyes, such as swimming.

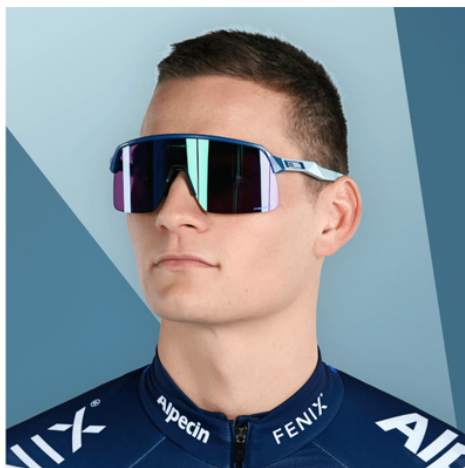

## Appendix C: existing products in the market

There are many options in the market similar to our design challenge thus the aim is to do Incremental development.

What exists:

Product	Ziena	EyeEco	7eye Airshield
Picture			
Commercial	Yes	Yes	Yes
Price	\$180	\$60	\$119
Where to buy?	Zienaeyewear.com	Bushburyeyecare.com	7eye.com
Features	<ul style="list-style-type: none"> <li>-Latex-free, silicone eye cup</li> <li>-Magnetic design</li> <li>-Sizes small, medium, large</li> <li>-Option between transparent or dark eye cup</li> </ul>	<ul style="list-style-type: none"> <li>-Cartridges on the side that house a type of sponge</li> <li>-Curved Frame (sportswear)</li> <li>-Flexible bridge</li> <li>-Extendable Temples</li> <li>-Anti Fog</li> </ul>	<ul style="list-style-type: none"> <li>-Non-air-permeable orbital seal</li> <li>-Multi-material eyecup that keeps moisture in and effectively blocks light, wind, and other irritants</li> <li>-Photochromic Lenses</li> </ul>